

# ADVANCE

Automation for sectional and counterweight spring doors up to 16m<sup>2</sup>

External control board, with control buttons



## NETLINK OPERATOR

This operator is compatible with the NETLINK System and can be programmed with DEAIstaller and NETBOX



Quick opening (17cm/s) and very silent, thanks to the steel track with belt



Reinforced belt with steel core

Standard rail with interlocking system 3200mm (art. AB16)

Two channel encoder

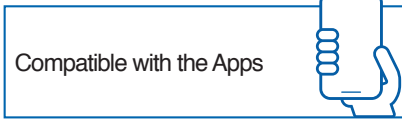

## 24V = operators with control board and encoder



COD.	Art.					OTHER CHARACTERISTICS
636052	ADVANCE	600N	✓		NET724N	<ul style="list-style-type: none"> <li>• Motor with 2 channels encoder</li> <li>• Separated control board with box, programming by display, Open/Close external push buttons, LED courtesy light</li> <li>• Built-in receiver for up to 100 remote controls</li> <li>• 3 steps simplified programming</li> <li>• Quick connection of the motor in the track</li> <li>• Continuous adjustment of the stroke and forces</li> <li>• Secured programming procedure</li> </ul>
636061	ADVANCE/XL	1200N	✓		NET724N/XL	

All models: control panel with box for wall mounting and 1 transmitter art. GT14 included. **Track not included.**

### Iron track with belt:

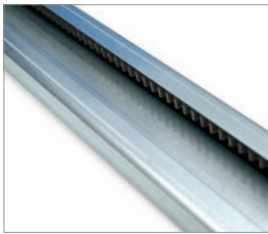

COD.	Art.	CHARACTERISTICS
636090	AB16	Steel track with belt, 2 pcs, 1.600+1.600 mm ADVANCE series: useful stroke: 2.776 mm
636093	AB20*	Iron track with belt, 2 pcs., 2.000 + 2.000 mm ADVANCE series: useful stroke: 3.576 mm

\*Recommended: to use with art. AB/BRACKET cod. 639381

TECHNICAL INFO	ADVANCE	ADVANCE/XL
Motor power supply (V)	24V =	
Maximum power absorption (W)	100	180
Max thrust (N)	600	1200
Duty cycle (cycles/hours)	20	25
N. max cycles in 24h.	60	75
Operating temperature (°C)	-20 ÷ 50	
Speed (cm/s)	17	16
Weight with packing (Kg)	4	
Sound pressure (dBA)	< 70	
Protection level	IPX0	

### DOOR SIDE INSTALLATION

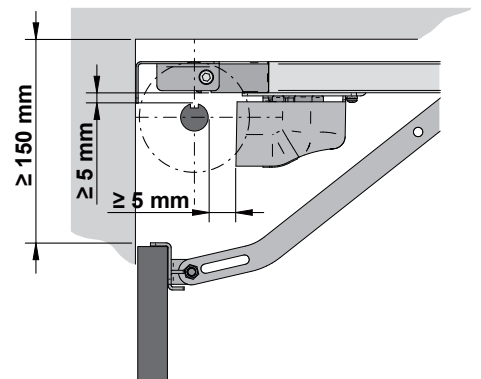
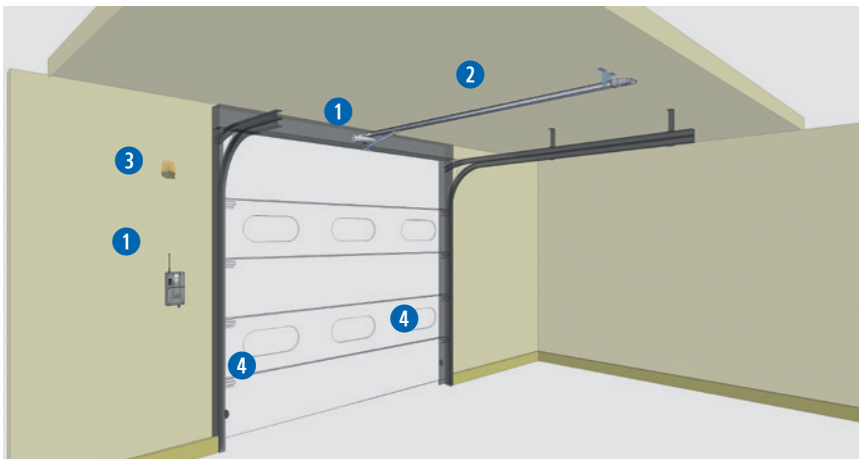

## STANDARD SIDE INSTALLATION

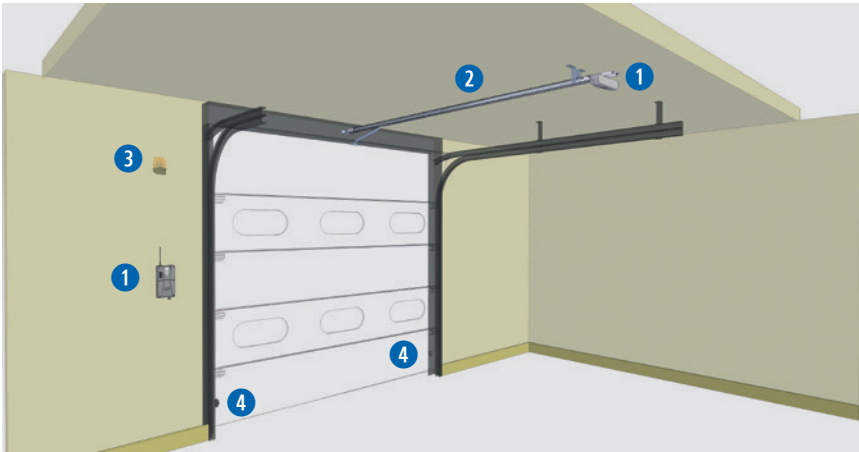

## DIMENSIONS

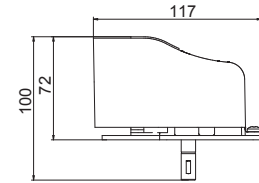
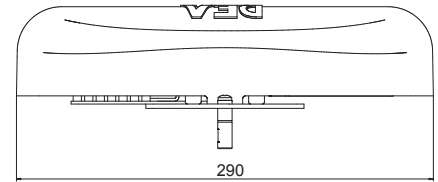

**KIT**

**1**

**Art. ADVANCE**  
1 operator ADVANCE - 24V with separated control board

**KIT**

**2**

**COD. 636090**  
**Art. AB16**  
Iron track with belt, 2 pcs., 1.600 + 1.600 mm

**KIT**

**COD. 672645**  
**Art. GT14**  
Serialized white 4-channel remote control, 433 MHz, with 3 coding: HCS Rolling-Code, Dip-Switch and new D.A.R.T. coding

**3**

**COD. 661083**  
**Art. AURA24**  
24V flashing light, LED, with integrated antenna, 433 MHz

**4**

**COD. 662080**  
**Art. LINEAR/XS**  
Pair of mini synchronizable photocell for outdoor installation. Maximum range 20m

**KIT** for further details on the kits see price list 2019

## SPECIFIC ACCESSORIES

**COD. 639381**  
**Art. AB/BRACKET**  
Fixing plate set for track

**COD. 639382**  
**Art. AB/FM**  
Mechanical stop in opening position for track with belt. Compulsory usage with "Electronic positioning brake" function enabled

**COD. 639301**  
**Art. AB/EXTENSION**  
1600mm extension for steel track art. AB16 complete with joint and 9450 mm full belt

**COD. 639350**  
**Art. 723**  
Arm adaptor for sectional doors

**COD. 639321**  
**Art. 721/AB**  
Unlocking device by cable (4m). To be used with art. BLINDOS

**COD. 639340**  
**Art. 722**  
Arm to be used with counterweight doors

**COD. 639590**  
**Art. BAT/ADV**  
Battery set for ADVANCE/SPACE

**COD. 639372**  
**Art. 762C**  
Unlocking device by cable with lock

**COD. 179006**  
**Art. 240E**  
Supplementary antenna for SPACE operators

**COD. 639600**  
**Art. PLUG CABLE/ADV**  
Multi-section shielded cable for ADVANCE L=5m

**COD. 665000**  
**Art. BLINDOS**  
Aluminium safety enclosure, with European cylinder, ready for unlocking device by cable.

**COD. 639371**  
**Art. 761C**  
Unlocking device by cable complete with hole cover lock

**COD. 639322**  
**Art. 721D**  
External unlocking device for ADVANCE/SPACE